

# TOYOTA AL252

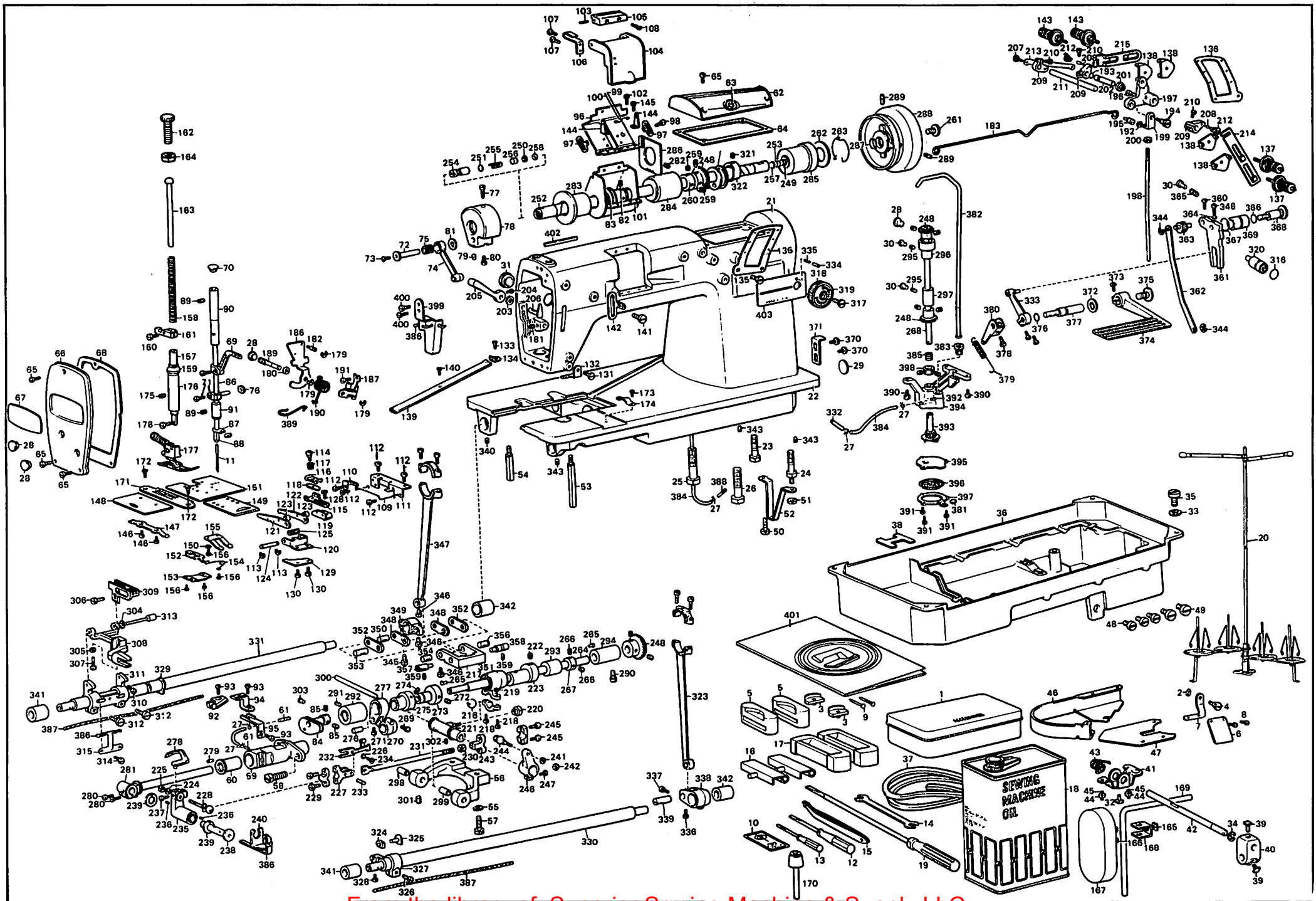

From the library of: Superior Sewing Machine & Supply LLC

# TOYOTA AL252

IDEN NO.	PARTS NAME	IDEN NO.	PARTS NAME	IDEN NO.	PARTS NAME	IDEN NO.	PARTS NAME
1	ACCESSORY BOX COMPLETE	82	SET SCREW FOR 83	164	NUT FOR 162	248	GEAR COMPLETE
2	SPRING WASHER FOR 7	83	THREAD (NEEDLE) TAKE-UP	165	SET SCREW FOR 168	249	SET SCREW FOR 253
3	CORNER RUBBER	84	THREAD (LOOPER) TAKE-UP	166	KNEE LIFTER PLATE	250	FLAT WASHER FOR 256
4	HINGE SCREW FOR 7	85	SET SCREW FOR 84	167	KNEE LIFTER PAD	251	RUBBER RING FOR 254
5	RUBBER BASE FOR BED	86	NEEDLE BAR ONLY	168	SUPPORT FOR 166	252	TOP SHAFT ONLY
6	NEEDLE GUARD WINDOW	87	NEEDLE CLAMP THREAD GUIDE	169	KNEE LIFTER ARM	253	TOP SHAFT OIL STOPPER
7	BRACKET FOR 6	88	NEEDLE CLAMP BODY	170	KNEE LIFTER PLUNGER	254	ADJUSTING VALVE FOR LUBRICATION
8	SET SCREW FOR 6	89	SET SCREW FOR 91, 90	171	NEEDLE PLATE	255	SPRING FOR 254
9	NAIL	90	NEEDLE BAR UPPER BUSHING	172	SET SCREW FOR 171	256	OIL FELT FOR 252
10	NEEDLE COMPLETE	91	NEEDLE BAR LOWER BUSHING	173	SET SCREW FOR 174	257	OIL STOPPER WASHER FOR 252
11	NEEDLE B-64 #80	92	NEEDLE GUARD	174	SPRING FOR 149	258	RUBBER WASHER
12	DRIVER MIDDLE	93	SET SCREW FOR 92, 94 & ETC	175	SET SCREW FOR 176	259	SET SCREW FOR 260
13	DRIVER SMALL	94	NEEDLE GUARD HOLDER	176	PRESSER BAR BUSHING	260	TOP SHAFT COLLAR
14	WRNCE	95	NEEDLE GUARD HOLDER BRACKET	177	HINGED FOOT COMPLETE	261	CAP SCREW FOR 288
15	PINCETTE	96	THREAD (NEEDLE) TAKE-UP STRIPPER PLATE	178	SET SCREW FOR 177	262	FELT FOR 285
16	BED HINGE	97	THREAD (NEEDLE) GUIDE B FOR 96	179	STOP RING FOR 189	263	RETAINER FOR 262
17	HINGE RUBBER	98	SET SCREW FOR 97	180	WASHER FOR 189	264	LOWER SHAFT ONLY
18	OIL	99	THREAD HOLD DOWN PLATE RIGHT	181	SET SCREW FOR 189	265	OIL STOPPER FOR 264
19	DRIVER LARGE	100	THREAD HOLD DOWN PLATE LEFT	182	HINGE SCREW FOR 186	266	SET SCREW FOR 267
20	SPOOL HOLDER	101	COVER FOR THREAD TAKE UP	183	KNEE LIFTER ROD	267	COLLAR FOR 264
21	ARM	102	SET SCREW FOR 99 & 100	186	KNEE LIFTER PLATE	268	VERTICAL SHAFT ONLY
22	BED	103	HINGE PIN FOR 104	187	SPRING CLAMP FOR 190	269	SET SCREW FOR 270
23	SET SCREW REAR FOR 22	104	COVER PLATE FOR 83	189	CONNECTING FOR 186	270	LOOPER FEED LIFTING CRANK
24	SET SCREW FRONT FOR 22	105	HINGE ARM	190	SPRING FOR 186	271	SET SCREW FOR 276
25	SET SCREW REAR FOR 22	106	SPRING FOR 104	191	SET SCREW FOR 187	272	SET SCREW FOR 273
26	SET SCREW FRONT FOR 22	107	SET SCREW FOR 106	192	STOP RING FOR 195	273	LOOPER FEED CAM A
27	OIL HOSE FOR CLEP	108	TENSION SCREW FOR 105	193	RUBBER RING FOR 202	274	SET SCREW FOR 275
28	PLUG FOR 66	109	SPRING FOR 84	194	HINGE SCREW FOR 199	275	LOOPER FEED CAM B
29	PLUG FOR BED HOLE	110	THREAD (LOOPER) GUIDE RIGHT	195	HINGE SCREW FOR 197	276	HINGED PIN FOR 277
30	PLUG FOR SCREW HOLE	111	COVER PLATE FOR 84	196	SET SCREW FOR 197	277	LOOPER FEED LIFTING JOINT
31	PLUG FOR 78	112	SET SCREW FOR 109, 110, 111	197	KNEE LIFTER LINK	278	LOOPER
32	SET SCREW FOR 41	113	STOP RING FOR 124	198	KNEE LIFTER PULL	279	OIL FELT
33	PACKING FOR 35	114	SET SCREW FOR 116	199	KNEE LIFTER BELL CRANK LINK	280	SET SCREW FOR 281
34	STOP RING FOR 42	115	TENSION THREAD GUIDE (LOOPER)	200	NUT FOR 198	281	LOOPER HOLDER LOCK SHAFT
35	DRAIN PLUG	116	TENSION UPPER PLATE (LOOPER)	201	BUSHING FOR 202	282	SET SCREW FOR 284
36	OIL PAN	117	TENSION SPRING (LOOPER)	202	HINGE PIN FOR 197	283	TOP SHAFT FRONT BUSHING
37	OIL PAN GASKET	118	TENSION LOWER PLATE (LOOPER)	203	OIL SEAL FOR 206	284	TOP SHAFT CENTER BUSHING
38	OIL FELT FOR 36	119	THREAD (LOOPER) TAKE-UP PLATE	204	SET SCREW FOR 205	285	TOP SHAFT REAR BUSHING
39	SET SCREW FOR 40	120	HINGE HOLDER FOR 124	205	PRESSER BAR LIFTER LEVER	286	OIL STOPPER FOR FELT
40	KNEE LIFTER ARM JOINT	121	THREAD (LOOPER) TAKE UP GUIDE	206	FULCRAM FOR 205	287	PACKING FOR 288
41	KNEE LIFTER CONTROLLER	122	THREAD (LOOPER) HOLD DOWN PLATE	207	JOINT SCREW FOR 213	288	HAND WHEEL
42	KNEE LIFTER SHAFT	123	SPACER FOR 121, 122, 119	208	HINGE SCREW FOR 209	289	SET SCREW FOR 288
43	SPRING FOR 41	124	HINGED PIN FOR 120	209	TENSION RELEASE SHAFT CRANK	290	SET SCREW FOR 294
44	NUT FOR 45	125	SPRING FOR 120	210	SET SCREW FOR 209	291	SET SCREW FOR 292
45	ADJUST SCREW FOR 41	126	SET SCREW FOR 115	211	TENSION RELEASE SHAFT	292	LOWER SHAFT FRONT BUSHING
46	BELT COVER BASE	127	SPRING FOR 120	212	SPRING FOR 208	293	LOWER SHAFT CENTER BUSHING
47	COVER PLATE FOR 46	128	SET SCREW FOR 129, 120	213	TENSION RELEASE CONNECTING ROD	294	LOWER SHAFT REAR BUSHING
48	SET SCREW FOR 47	129	SET SCREW FOR 132	214	TENSION (NEEDLE THREAD) RELEASER	295	SET SCREW FOR 296, 297
49	SET SCREW FOR 46	130	SET SCREW FOR 132	215	TENSION (LOOPER THREAD) RELEASER	296	VERTICAL SHAFT UPPER BUSHING
50	SET SCREW FOR 52	131	THREAD (NEEDLE) GUIDE LOWER	216	LOOPER DRIVING BALL STUD	297	VERTICAL SHAFT LOWER BUSHING
51	NUT FOR 52	132	SET SCREW FOR 134	217	LOOPER BALL CRANK CONNECTION	298	BUSHING REAR FOR 300
52	BED LEG RIGHT	133	THREAD (LOOPER) GUIDE	218	SET SCREW FOR 217	299	BUSHING FRONT FOR 300
53	BED LEG FRONT	134	SET SCREW FOR 136	219	NUT FOR 218	300	HINGE SHAFT FOR 221
54	BED LEG REAR	135	THREAD GUIDE ARM TOP	220	NUT FOR 221	301	SET SCREW FOR 298, 299
55	SPRING WASHER FOR 57	136	TENSION (NEEDLE THREAD) COMPLETE	221	LOOPER BALL CRANK	302	SET SCREW FOR 221
56	LOOPER BALL CRANK HOLDER	137	TENSION THREAD GUIDE	222	SET SCREW FOR 223	304	FLAT WASHER FOR 313
57	SET SCREW FOR 56	138	THREAD (LOOPER) TUBE COMPLETE	223	LOOPER FEED ECCENTRIC	305	NUT FOR 307
58	SET SCREW FOR 59	139	SET SCREW FOR 139	224	SPRING WASHER FOR 228	306	CLAMP SCREW FOR 309
59	LOOPER HOLDER ROCK SHAFT SUPPORT	140	SET SCREW FOR 142	225	NUT FOR 228	307	ADJUSTING SCREW FOR 309
60	BUSHING FOR 59	141	THREAD (NEEDLE) EYELET	226	WASHER FOR 234	308	FEED BAR
61	OIL HOSE NIPPLE	142	TENSION (LOOPER THREAD) COMPLETE	227	PITMAN HEAD LEFT	309	FEED DOG
62	TOP COVER PLATE	143	THREAD (NEEDLE) GUIDE A FOR 96	228	LOOPER DRIVING BALL STUD	310	SET SCREW FOR 313
63	OIL GAUGE WINDOW	144	SET SCREW FOR 144	229	SET SCREW FOR 227	311	FEED BAR BELL CRANK
64	GASKET FOR 62	145	SET SCREW FOR 147	230	LOCK NUT FOR 231	312	SET SCREW FOR 311
65	SET SCREW FOR 62	146	SPRING FOR 148	231	LOOPER BALL CRANK PITMAN ROD	313	FEED BAR SHAFT
66	FACE COVER PLATE	147	SLIDE PLATE COMPLETE	232	SPRING FOR 231	314	SET SCREW FOR 315
67	NAME PLATE	148	LAP SEAM FELLER SET PLATE	233	PIN FOR 231	315	OIL WICK RETAINER
68	GASKET FOR 66	149	WASHER FOR 156	234	SET SCREW FOR 232	316	RUBBER RING FOR 320
69	TAKE UP LEVER COMPLETE	150	ORNAMENT COVER PLATE	235	LOOPER HOLDER	317	LOCK SCREW FOR 318
70	CAP FOR 90	151	STOPPER FOR 151	236	SPRING PIN FOR 239	318	FEED REGULATOR DIAL BASE
71	NEEDLE BAR BRACKET COMPLETE	152	GUIDE FOR 152	237	SET SCREW FOR 278	319	FEED REGULATOR DIAL PLATE
72	NEEDLE BAR CRANK PIN	153	SPRING FOR 152	238	HINGE PIN FOR 235	320	FEED REGULATOR DIAL SHAFT
73	OIL STOPPER SCREW FOR 72	154	SPRING FOR 151	239	WASHER FOR 238	321	SET SCREW FOR 322
74	NEEDLE BAR CRANK ROD	155	SET SCREW FOR 155	240	OIL WICK RETAINING	322	FEED CAM
75	NEEDLE BEARING COMPLETE	156	PRESSER BAR ONLY	241	SPRING WASHER FOR 244	323	FEED ROCK CONNECTING ROD
76	SLIDING BLOCK FOR 74	157	PRESSER SPRING	242	NUT FOR 244	324	SLIDING BLOCK FOR 308
77	SET SCREW FOR 78	158	OIL GUARD FOR 157	243	PITMAN HEAD RIGHT	325	SLIDING BLOCK SHAFT
78	TAKE UP LEVER CRANK	159	SET SCREW FOR 161	244	LOOPER DRIVING BALL STUD	326	SET SCREW FOR 327
79	SET SCREW FOR 72	160	PRESSER BAR GUIDE BRACKET	245	SET SCREW FOR 243	327	FEED LIFTING BELL ARM
80	CLAMP SCREW FOR 72	161	PRESSER REGULATOR SCREW	246	LOOPER BALL CRANK ARM	328	SET SCREW FOR 325
81	THRUST WASHER FOR 74	162	PRESSER REGULATOR ROD	247	SET SCREW FOR 246	329	RUBBER FLANGE
		163					
						330	FEED LIFTING SHAFT ONLY
						331	FEED ROCK SHAFT ONLY
						332	OIL HOSE NIPPLE
						333	FEED REGULATOR ARM
						334	FEED REGULATOR DIAL PIN
						335	FEED REGULATOR DIAL SPRING
						336	SET SCREW FOR 338
						337	SET SCREW FOR 339
						338	FEED LIFTING BELL CRANK
						339	HINGED PIN FOR 338
						340	SET SCREW FOR 341
						341	FRONT BUSHING FOR 330 & 331
						342	REAR BUSHING FOR 330 & 331
						343	SET SCREW FOR 341 & 342
						344	STOPPER RING FOR 356 & 363
						345	SET SCREW FOR 349
						346	SET SCREW FOR 354, 350, 353 & ETC
						347	FEED LIFTING CRANK ROD
						348	FEED ROCK JOINT
						349	FEED ROCK ARM
						350	FEED ROCK CONNECTING SHAFT
						351	FEED REGULATOR BODY
						352	FEED ROCK OUTER JOINT
						353	FEED LINK SHAFT A
						354	FEED LINK SHAFT B
						356	FEED LINK SHAFT C
						357	FEED REGULATOR SHAFT A
						358	FEED REGULATOR SHAFT B
						359	SET SCREW FOR 357 & 358
						360	SET SCREW FOR 363
						361	FEED REGULATOR CAM
						362	FEED REGULATOR ROD
						363	ADJUSTING PIN FOR 362
						364	PAD FOR 346
						365	SET SCREW FOR 369
						366	RUBBER RING FOR 368
						367	RUBBER RING FOR 369
						368	FEED REGULATOR SHAFT FOR 361
						369	FEED REGULATOR BUSHING
						370	SET SCREW FOR 371
						371	LEVER STOPPER
						372	WASHER FOR 377
						373	SET SCREW FOR 374
						374	HAND LEVER FOR FEED REGULATOR
						375	CAP SCREW FOR 374
						376	RUBBER RING FOR 377
						377	REGULATOR SHAFT
						378	SET SCREW FOR 380
						379	SPRING FOR 377
						380	RETAINER FOR 379
						381	MAGNET
						382	OIL FEED TUBE
						383	NUT FOR 382
						384	OIL HOSE
						385	SPRING JOINT
						386	OIL WICK FOR 240
						387	OIL WICK FOR 330 & 331
						388	OIL HOSE NIPPLE
						389	OIL HOSE CLAMP
						390	SET SCREW FOR 394
						391	SET SCREW FOR 397
						392	OIL HOSE NIPPLE
						393	OIL PUMP IMPELLER
						394	OIL PUMP BODY
						395	OIL PUMP COVER
						396	OIL PUMP FILTER
						397	OIL PUMP FRAME
						398	OIL PUMP COLLAR
						399	OIL WICK RETAINER
						400	SET SCREW FOR 399
						401	INSTRUCTION BOOKLET
						402	SUB NAME PLATE
						403	MODEL PLATE